

# Perennial Garden Plan

DOWNLOADABLE PLAN & SHOPPING LIST

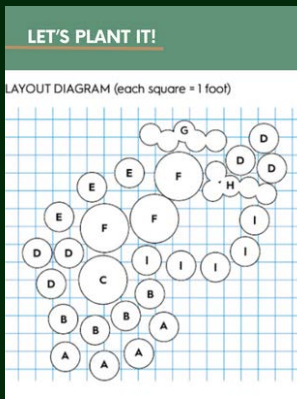

Schwartz's  
Greenhouse

# #GardenGoals



# What's What



Garden Phlox

Coneflower

Russian Sage

Lavender

Catmint

Common Yarrow

Adobe Stock | #229428301



**Schwartz's  
Greenhouse**

**PERENNIAL GARDEN PLAN**

# A Closer Look:



**Russian Sage**



**Coneflower**



**Yarrow**



**Lavender**



**Garden Phlox**



**Catmint**

# Save Your Shopping List

## PLAN LIST:



Russian Sage



Lavender



Coneflower



Catmint



Yarrow



Garden Phlox

Find them all at Schwartz's  
Greenhouse this spring!

**30705 SIBLEY RD. ROMULUS, MI 48174**  
**(734) 753-9269**



**Schwartz's  
Greenhouse**

PERENNIAL GARDEN PLAN

# Planting Guide

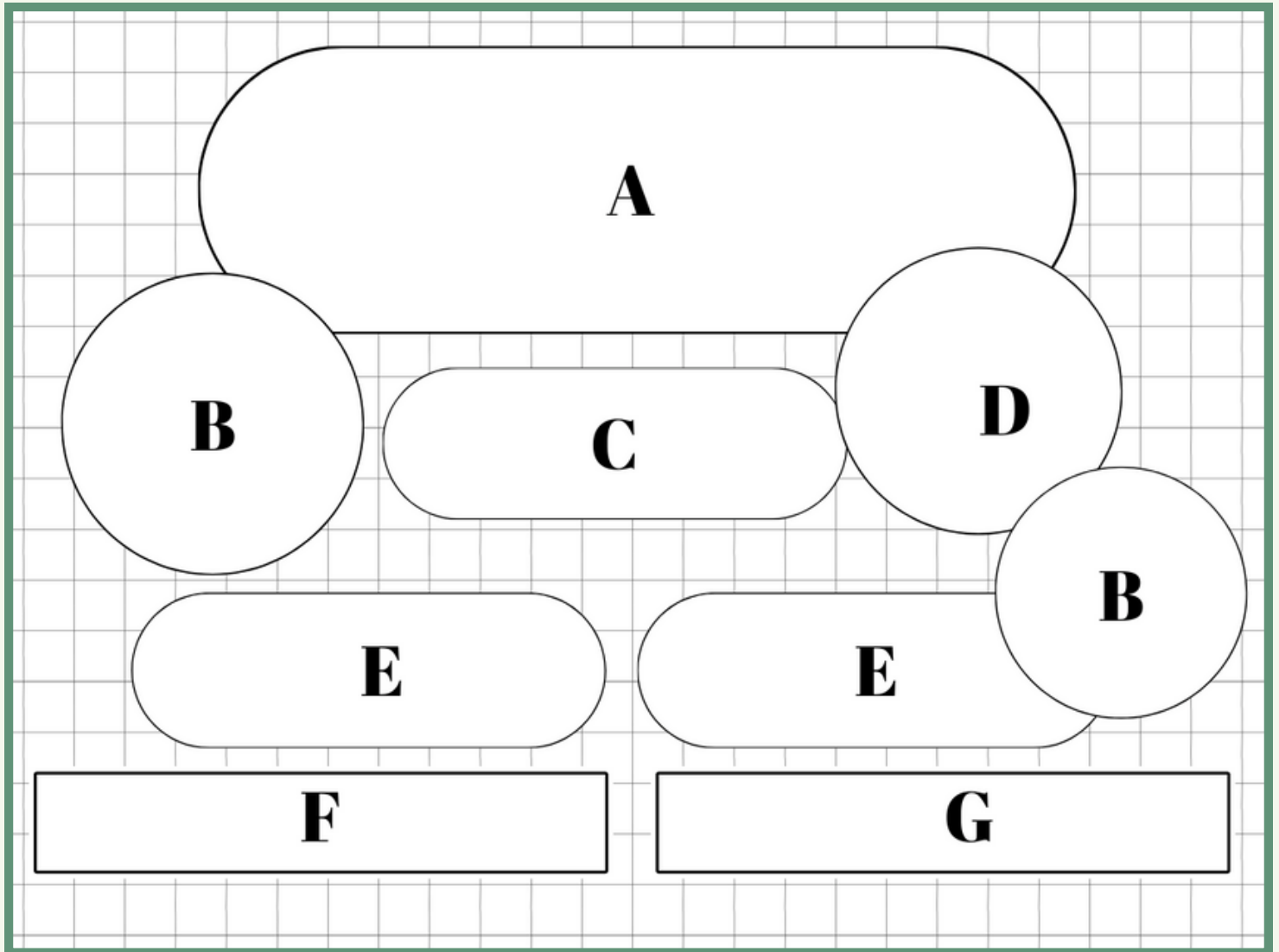

**A** – Russian Sage

**B** – Garden Phlox

**C** – Coneflower

**D** – Penstemon

**E** – Yarrow

**F** – Lavender

**G** – Catmint



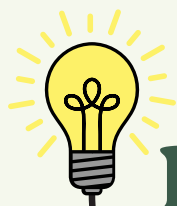

# Planting Tips

- Plant in a sunny area (6-8 hours of full sun daily is best!)
- All of these are drought-tolerant once established
  - water regularly during the first few months/season, then less will be needed
- Almost all of these plants will spread quite a bit. Consider planting each individual plant 1-2' apart to leave room for growth

**Question:** Do I have to plant all 7 of these plants? Is it okay to pick and choose?

**Answer:** You are more than welcome to mix and match perennials from this plan along with others that we offer! This plan is simply a suggestion for those looking for a wide variety in their home garden. Any combination of these flowers will add long-lasting beauty to your garden.

